

ORE Locker Switch Kit  
For 2007 and newer Jeep Wrangler  
Off Road Engineering  
(949) 581 2991

1. Disconnect the positive and negative battery terminals and remove the battery from the vehicle to gain access to the locker relays located next to the battery on the passenger side fender.
2. Refer to the wiring diagram on the last page for the installation, figure 6. Remove the locker relay assembly from the fender and locate the violet with dark blue stripe wire coming out of the front locker relay socket, and the violet with light green stripe wire coming out of the rear locker relay socket. See figure 2. Connect a red Posi-Tap connector to each violet wire. Do not cut the violet wires, insert them into the notch on the Posi-Tap connector as shown in figure 1. The wires from the locker switches will be inserted into the Posi-Tap connectors once the switches have been mounted and the harness routed through the fire wall.

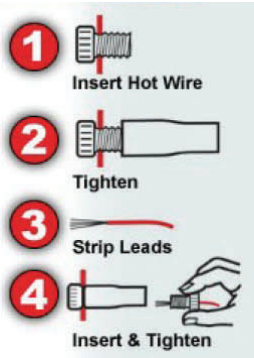

Figure 1

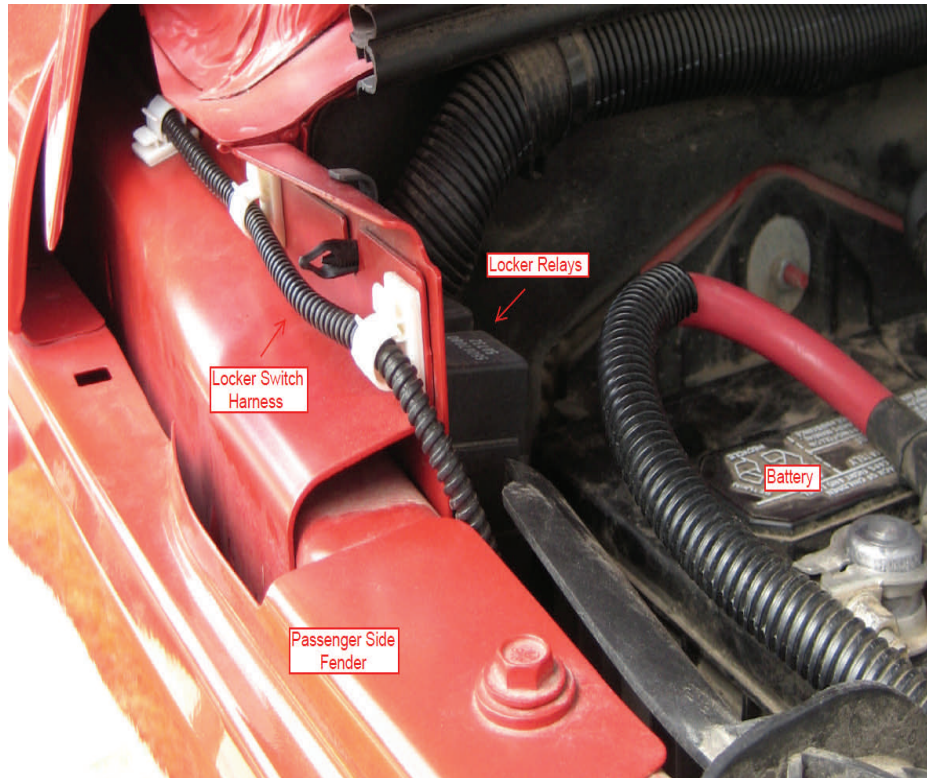

Figure 2

3. **Follow the next several steps if you wish to mount the locker switches to the left of the radio, *otherwise* drill two 9/16" holes in the desired location and skip to step 7.**
4. Remove the panel above the radio by prying up from the back of the panel. Then remove the bottom panel at the very bottom below the climate controls by unsnapping it from the top. Remove all bolts holding the center console panel, then unsnap the panel.
5. Remove the 2 screws securing the left side of the radio, and replace them with the screws supplied in the kit. This will provide additional clearance for the locker switches. See figure 3.
6. Drill two 9/16" holes for the locker switches in the panel to the left of the radio. A uni bit or a step drill bit works great for this. Center the top hole 1/2" from the top of the panel and 1/2" from the left side of the panel. Center the bottom hole 1/2" from the bottom of the panel and 1/2" from the left side of the panel. See figure 4.  
**Before drilling make 100% sure that the switches will not interfere with anything!**
7. Feed the locker switch wires through the holes, screw on the nuts and tighten from behind.
8. Install the locker disable switch in a desired location. Drill a 1/4 inch hole and secure the switch with the hardware.
9. Connect the black wires from the locker switches to one of the black locker disable wires using a crimp terminal. Connect the other black locker disable switch wire to the black with white stripe wire (ground) on the left accessory outlet using a blue Posi-Tap connector. See figure 1. *Be careful when routing the wires, not to interfere with the climate controls.*
10. Route the two red wires from the locker switches to the left accessory outlet and connect to the blue with pink stripe wire (+12V) using a blue Posi-Tap connector. See figure 1. *Be careful when routing the wires, not to interfere with the climate controls.*



Figure 3



Figure 4

11. Insert the blue and green wire from the locker switches into the wire loom and route them above the glove box to the firewall passthrough located to the right of the passenger right vent. Remove the panel on the right side of the dash to gain access. See figure 5.
12. Use a coat hanger to puncture the rubber seal inside the feedthrough and then route the blue and green wires inside the wire loom into the engine compartment and cut to length to reach the locker relays.
13. Insert the green wire into the Posi-Tap connector connected to the violet with light green stripe wire (Rear Locker).
14. Insert the blue wire into the Posi-Tap connector connected to the violet with dark blue stripe wire (Front Locker).
15. Install the relay assembly back onto the fender. Use the supplied cable clamps to secure the wire loom. Use the supplied wire ties to properly secure all wires. See figure 2.
16. Install all panels back in their places and install battery and connect the positive and negative terminals.
17. Test the locker switches. The lights will illuminate when the switches are depressed and the corresponding locker light on the dash will flash.

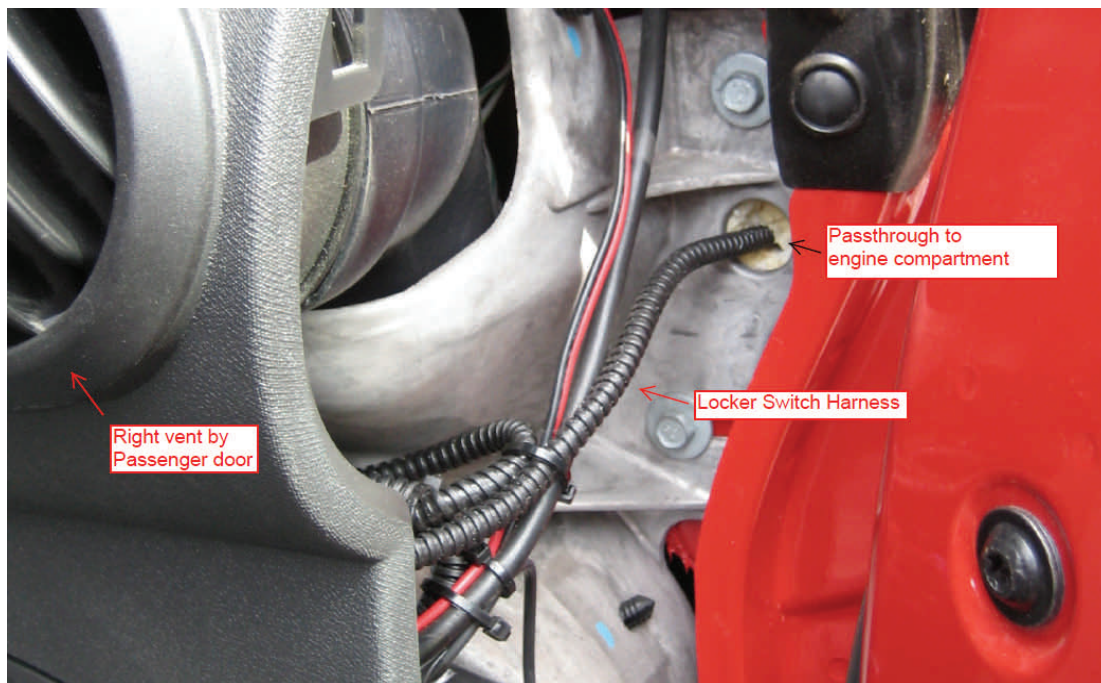

Figure 5

## **WARNING**

- Do not activate the lockers above 10 mph, failure to comply with this warning may result in damage to the differentials
- Disable the locker switches with the locker disable switch when not traveling off road

